



**COMPUTER FREEHOLD REGISTER
UNDER LAND TRANSFER ACT 1952
Limited as to Parcels**



Historical Search Copy

R. W. Muir
Registrar-General
of Land

Identifier NA1816/62
Land Registration District North Auckland
Date Issued 10 March 1960

Prior References

NA577/196

Estate Fee Simple
Area 7.0694 hectares more or less
Legal Description Part Allotment 1 Parish of Mangawhai

Original Proprietors

The Mangawhai Domain Society (Incorporated)

Interests

K73329 Building Line Restriction
Fencing Agreement in Transfer 635253 - 10.3.1960

NORTH REGISTER

Land and Deeds
FORM No. 2

1816/62

Reference: Vol. 577, Folio 196
Transfer No. 635253
Order for N/C No.



NEW ZEALAND

Register-book,
Vol. 1816, folio 62

CERTIFICATE OF TITLE UNDER LAND TRANSFER ACT LIMITED AS TO PARCELS

This Certificate, dated the tenth day of March, one thousand nine hundred and sixty under the hand and seal of the District Land Registrar of the Land Registration District of AUCKLAND WITNESSETH that THE MANGAWHAI DOMAIN SOCIETY (INCORPORATED) AS MANGAWHAI

1816/62

is seized of an estate in fee-simple (subject to such reservations, restrictions, encumbrances, liens, and interests as are notified by memorial under written or endorsed hereon, subject also to any existing right of the Crown to take and lay off roads under the provisions of any Act of the General Assembly of New Zealand) in the land hereinafter described, as the same is delineated by the plan hereon bordered green, be the several admeasurements, a little more or less, that is to say: All that parcel of land containing 17 ACRES 1 ROOD 35 PERCHES more or less being part of Allotment 1 Parish of Mangawhai Part of Mangawhai Parish Lot 87 Dist. Man. 1838

23/1/24

1816/62

III. Mangawhai S. D.

EQUIVALENT METRIC AREA IS 7.0693 ha
7.0693 ha

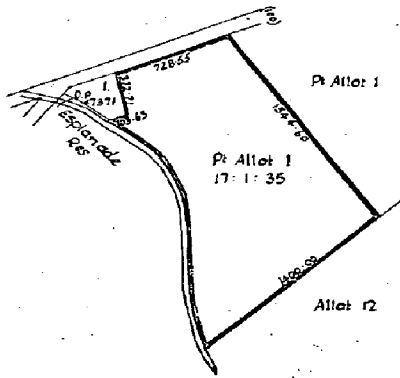

NOT TO SCALE
DLS: ew



J. Bennett
District Land Registrar,
Assistant

Building line restriction contained in K.73329
Agreement as to fencing contained in Transfer 635253
Mortgage 482742 to Bank of New Zealand District of Man.
Produced to District Land Registrar District of Man.

THIS REPRODUCTION (ON A REDUCED SCALE) CERTIFIED TO BE A TRUE COPY OF THE ORIGINAL REGISTER FOR THE PURPOSES OF SECTION 215A LAND TRANSFER ACT 1952

B.164732.1 Mortgage to Manukau County Council - 13.4.1983 at 9.07 o/c

B.702520.1 Manukau County Council - A.L.R.

B.361297.1 Mortgage to Manukau County Council - 12.2.1985 at 9.07 o/c

B.988921.1 Variation of terms of Mortgage B.361297.1 - 9.5.1989 at 9.07 o/c

A.L.R.

